

## Proline® - Polypropylene (PP)

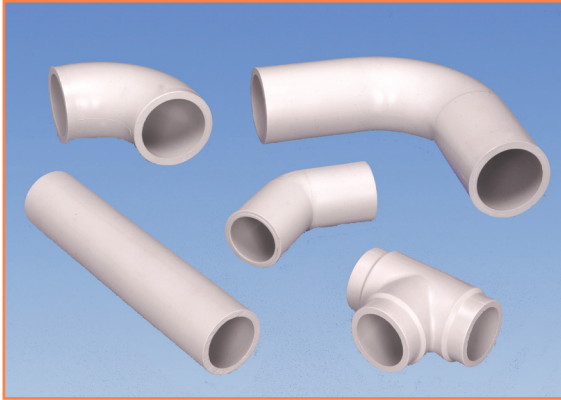

Proline® piping systems are made from the highest quality copolymer polypropylene resins. Proline® is suitable for a wide range of applications with a pH range from 1 to 14 and at temperatures over 140°F. Proline® copolymer resins exhibit better properties than homopolymer polypropylene. As such, Proline® is the best choice for process waste drains that typically see varying media and temperatures. Proline® uses fusion joining technology with socket, butt and electrofusion available to meet your application requirements.

Asahi/America offers a full range of molded fittings and fabricated specialty drainage fittings such as wyes, P-traps, laterals.

### Supply Range

#### Pipe and Fittings

- 20 - 1200mm (1/2" - 48") SDR 11, 150 psi
- 110 - 1400mm (4" - 55") SDR 33, 45 psi

#### Valves

- Type-21 Ball Valves: 20 - 110mm (1/2" - 4")
- Type-57 Butterfly Valves: 50 - 1400mm (1-1/2" - 55")
- Type-14/15/G Diaphragm Valves: 20 - 200mm (1/2" - 10")
- Ball Check Valves: 20 - 110mm (1/2" - 4")
- Frank Series Regulating Valves: 20 - 110mm (1/2" - 4")

#### Welding Methods

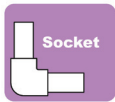

### Pressure Rating

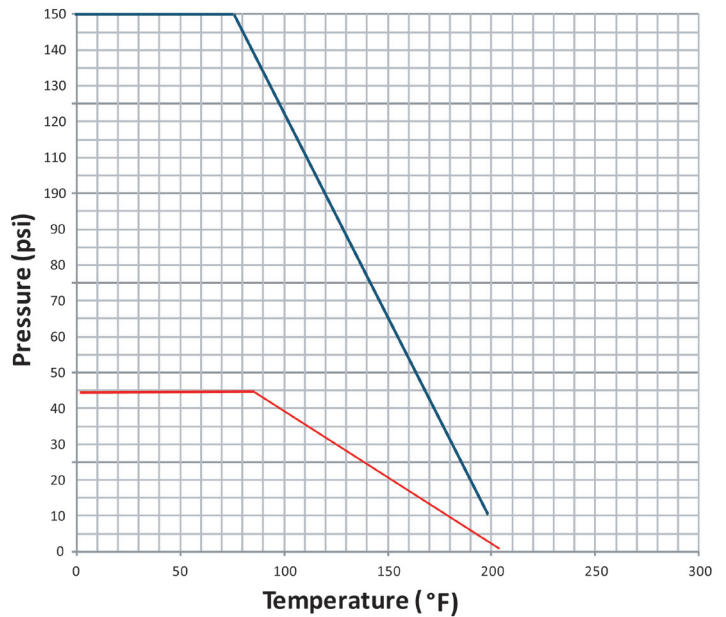

### Resins

Asahi/America's Proline® PP utilizes the best materials throughout the entire product size range. Proline® is produced with random copolymer resin 20 - 500mm (1/2" - 20"), SDR 11 pipe and homopolymer resin in sizes greater than 500mm (20"), SDR 17 and 33.

Random copolymer resin exhibits higher weld strength, impact resistance and faster relaxation due to lower modulus of elasticity.

All resins used for Proline® pipe are  $\beta$  nucleated (PP-beta) resin.

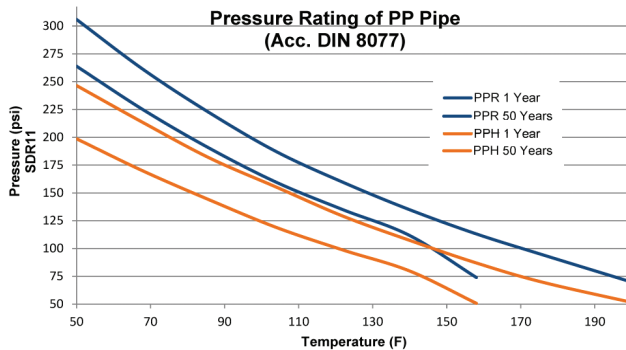

## Proline® Ideal Applications

- pH range 1-14
- Process Chemical & Waste
- Caustic
- Acids
- Industrial Water

